

# ***RICHMOND RANCH***

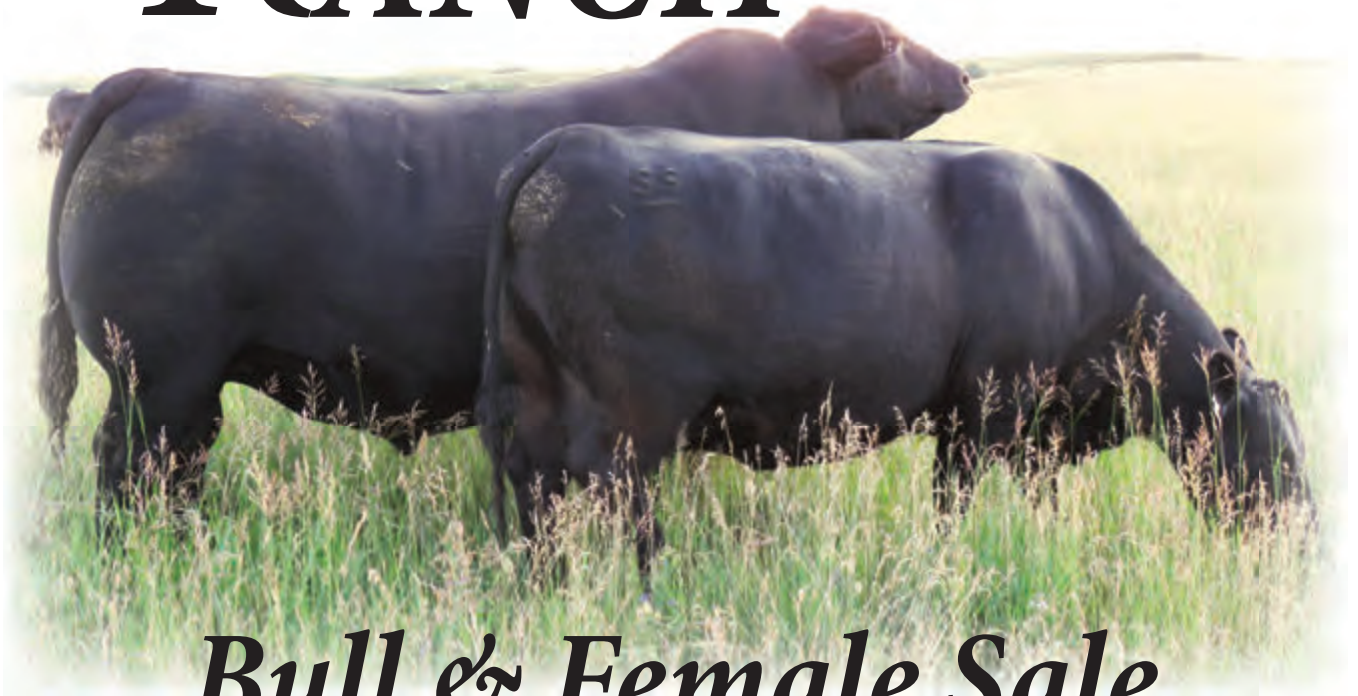

## ***Bull & Female Sale***

***Thursday February 16, 2023 at the Ranch, Rumsey AB***





# RICHMOND RANCH

**26<sup>th</sup> Annual Bull & Female Sale**  
**1:00 p.m. Thursday February 16<sup>th</sup>**  
**@ The Ranch, Rumsey AB**

## Sale Day Phones:

Tiffany's Cell.....403-740-3748  
Jim's Cell.....403-323-8433  
Stephanie's Cell.....403-323-7269  
Samantha's Cell .....403-741-7262  
Brandon's Cell.....403-741-2675  
Home.....403-368-2103

## Auctioneer:

Dan Skeels. ....403-783-1217

## Sales Representatives & Consultants:

Rod McLeod.....403-540-7986  
Dean Edge.....403-704-0280  
Andrew Reeleder.....403-848-1260  
Martin Bohrsen - Bohrsen Marketing.....306-220-7901  
Jaxon Payne - Bohrsen Marketing.....306-830-0456  
Mark Shologan - DLMS .....780-699-5082  
Mark Holowaychuk - OBI Livestock Ltd..403-896-4990  
Kurt Pederson - OBI Livestock Ltd.....780-209-9999  
Roger Peters - OBI Livestock Ltd .....403-828-9815  
Dylan Benjamin.....403-741-6852  
Gary Rairdan.....403-740-6823

## Videos available to view online @

[www.richmond ranch.com](http://www.richmond ranch.com)  
[www.dlms.ca](http://www.dlms.ca) [www.bohrson.com](http://www.bohrson.com)  
[www.cattlemanagement.ca](http://www.cattlemanagement.ca)

## Can't make it to the sale? Internet Bidding Available.

To view this sale visit [www.dlms.ca](http://www.dlms.ca), Fill out the registration form located under registration and sign-up for your free user account and select a username and password.

**BIDDERS** - To be approved as a bidder, Log in to [dlms.ca](http://dlms.ca) and click BUYER APPROVAL tab, select the sale you are interested in bidding at and click sign up.

## For more information

Call DLMS Reps:

Mark Shologan - 780-699-5082 or  
DLMS Purebred Team 780.991-3025

**DLMS**  
[www.dlms.ca](http://www.dlms.ca)

**Feb 10th-15th 2023. 10am-4pm. Daily.**

To ensure everyone has an opportunity to tour through the bulls efficiently we have added open houses with coffee and snacks available for the week prior to the sale. If you are looking for some more one-on-one time with us to help select your next herd bull, then be sure to take advantage of the week prior to the sale.



*Longevity ~ Quality ~ Integrity*



Give us a call and stop in anytime! The bulls can be set up and on display for your viewing convenience anytime prior to sale day.

**Thursday February 16th**

1:00 pm Richmond Ranch Bull & Female Sale

**Sale Location:** The sale will be held at the Ranch, 5 miles East of Rumsey, AB. In the new shop south of the pens.

**Directions from Stettler:** go South on HWY 56 about 60kms. Turn West onto HWY 585, go 1 mile and the farm is on the South side of the road on RgRd 202.

**Directions from Trochu:** go East on HWY 585 about 40kms. The farm is on the South side of the HWY on RgRd 202.

**Directions from Drumheller:** go North on HWY 56 about 60kms. Turn West onto HWY 585, go 1 mile and the farm is on the South side of the road on RgRd 202.

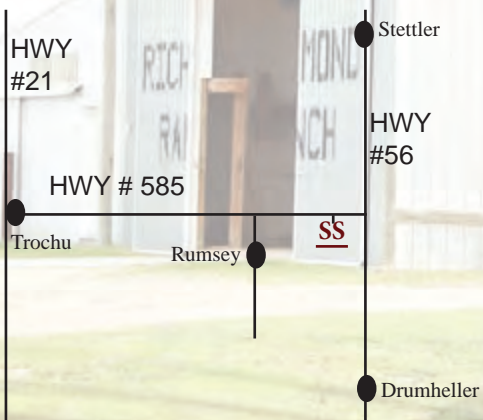

*Stop in for a visit and tour of the bull pen anytime!*







**26 years! 6 generations! 3 breeds! 1 Family run operation!**

It is both an honor and a privilege to be your herd bull source. As we approach the 2023 bull sale season it is a touching sentiment to our family each year to receive so much support from our family, friends, neighbors, and customers. We would like to extend a token of gratitude for their continued loyal support and confidence in our breeding program. The cattle business has been our way of life for 6 generations now and each year we are extremely humbled and could not be prouder to see our prefix flourish in herds across Canada. Being a family run operation, we take significant pride in our cattle and every year we set the bar to breed the type of cattle that will be sustainable in the beef industry, while focusing on the productivity and profitability for the cattlemen who sell quality pounds for a living. Here at Richmond Ranch, it has been our unwavering belief in cow-families and have emphasized on having only elite females retained in the herd. Our disciplined breeding program has focused on structure, soundness, udder quality, performance, and maternal production. You can be certain that behind this stout set of bulls is a very impressive, hardworking, and productive set of females.

As we present what we feel is one of our strongest bullpens yet, we will continue with our Breeding Protection Plan to help ensure your investment is protected and, furthermore, your cows are bred. Understanding the importance of your investment in a herd bull along with the expectations that come with that, we would like to assist you in any way we can to make your selection easier. We hope that you will mark your calendars and join us, Sale Day.

Sincerely,  
The Richmond Family











We will be offering our Breeding Protection Plan once again. Our goal is to help ensure your cows get bred and your investment is protected. We know that no matter how many precautions we take, bulls will be bulls, and injury or death is always a possibility. We still encourage that the best defense you can buy is a backup bull. One that you have selected, that stands ready in your yard. However, we understand this is not always an option for everyone and have designed our Breeding Protection Plan to better serve our valued customers.

With an additional 10% on the purchase price of your new bull \* \$500 minimum\* - The Breeding Protection Plan will give you 1 year protection against injury or death with either a replacement bull, a credit for a future bull sale, or a combination of the two. If you should have any problem with your bull – Make Richmond Ranch your first call. Jim or Stephanie at 403-323-8433 or 403-368-2103.

Richmond Ranch will do our best to resolve any issue with honesty and integrity to keep you a satisfied and repeat customer. That is our uncompromising commitment. Under our Breeding Protection Plan your bull is protected from injury, sickness, accident, structural breakdown, or death. The Breeding Protection Plan will not protect from any injury or death due to malicious, willful intentional acts of mistreatment.

Richmond Ranch retains the right to request photos.

Richmond Ranch retains the right to request a vet report or Postmortem.

Please feel free to give us a call anytime to discuss this Breeding Protection Plan

**EPD's are available upon request. They can be found on each respective breed association website.**



Homozygous or Hetero Polled	
PV-Parent Varified or SV-Sire Varified	
BW	Birth Weight
CR	Calving Rating
DOC	Docility Rating
Age of Dam at the time of calving	
Adjusted Weaning Weight @ 205 days old	
Jan 1 Weight	
GOG	Gain on Grass over 134 days
ADG	Average Daily Gain in pen 84 days

## STOCKMENS INSURANCE

Larry Toner

Phone (306)932-4866

Cell (306)834-7652

Email: [larrytoner@xplornet.com](mailto:larrytoner@xplornet.com)







### **Producing Cattle that GAIN on GRASS.**

The 2023 bull pen gained over 3 lbs. on grass

We are very proud of this offering. The purebred cattle here at Richmond Ranch are raised ranch style and calved out the way you calve, so the cattle will excel in ranch conditions. The do it themselves ranch cows stay out on native grass until late fall when the calves are weaned off. The calves are wintered in a 20-acre pen on a combination of quality forages ensiled to get them through the winter and back on Grass. This program is designed to develop cattle for longevity and success in any program. We have always selected cattle that thrive on grass, selecting powerful herd sires that stick to the basics of beef, thick and naturally fleshing. This past May 27th we took a weight on our sale bulls just before we sent them to grass. We brought them back home on Oct 8th for a weight off pasture. They went back to the pasture but were supplemented as grass was becoming dormant.

The Bulls came back to the yard Nov 12th for the winter to get ready for the sale.

We calculated the Gain on Grass from the May 27th weight and the Oct 8th weight. Over the 134 days the whole pen averaged 3.29 lbs. per day – (The Cheapest gain we can get!)

We have entered this data on each sale lot under “GOG” Gain on Grass.

We also calculated their Average Daily Gain from Oct 8th to their Jan 1st weight.

Over the 84 days the whole pen averaged 3.46 lbs. /day

We have entered this data on each lot under “ADG” Average Daily Gain.

**When pounds and profits matter, choose your next herd bull from quality genetics.**





**Cattle Nutrition:** At Richmond Ranch our goal is to develop the cattle for longevity and succeSS in any program. The bulls are fed a growing ration of corn and barley silage, chopped hay/straw, and a Bullseye supplement at 0.75%. This system allows us to grow the bulls to seek the performance while maintaining their natural muscle shape. Our goal is to not only have bulls looking good for sale day, but most importantly, looking great while working in your pasture during breeding.



New Date, same high quality!!! Feb 16th, 2023, plan to head to the ranch for an outstanding set of bulls. With the hot dry conditions forage volumes were "okay", but as predicted quality was high. I have had the pleasure to work along side the crew at Richmond Ranch to develop balanced diets that start with high-quality on-farm ingredients. The cow herd utilizes a customized mineral program that is balanced throughout the year. This supports proper bull calf development from a young age. The bull feeding program is built to maximize forage utilization and gut health; they are developed on grass with their moms and then moved onto a balanced TMR that promotes lean muscle. The bulls are challenged with a foraged based TMR to help them develop to their

genetic potential. Organic minerals are used to ensure proper immune function and overall health. This program uses a total nutrition program on their entire operation, ensuring optimal cattle performance. If you have any questions about the nutrition of the sale bulls, please feel free to call. Best of luck on sale day!

**Doug Roxburgh**  
*Beef Consultant*  
**(403) 392-4541**

[doug.roxburgh@bullseyefeeds.ca](mailto:doug.roxburgh@bullseyefeeds.ca)



**Vaccination Programs:** All our livestock are on the Express Verified Program as well as given a combination of Safe Guard, Clean-up 2 and Ivomec for parasite control. The calves are vaccinated and bolstered with Pyramid FP5 and Presponse SQ and Fermicon 7/Somnugen.

**Breeding Females:** In addition to the above, our females receive an annual shot of Express FP 5 VL5 prior to breeding. The bred females get vaccinated with Scour Bos.

**Semen Testing:** All bulls have been tested, measured and palpated through the Stettler Veterinary Clinic by Veterinarian Dr. Jackie Dobinson.

*If you're reading this, you are likely considering this great offering of bulls and females and everything that they will bring to your herd. Quality herd sires offer the fastest way to impact genetic potential in your herd. From a veterinary perspective, we often encourage producers to know the health of the animal they are bringing in to ensure that it's going to be a good fit. Richmonds due dilligence is spot on. The vaccination and health program at Richmond Ranch is the gold standard of veterinary recommendations. From a reproduction standpoint, everything in this sale is reproductively sound with a veterinary breeding soundness examination and their own responsible breeder guarantee. Health is directly linked to production and production is directly linked to dollars. Years of experience here and sound practices make up the quality you'll see flipping through these pages. We are proud to work with Richmond Ranch and congratulate them on another great offering!*

Sincerely,  
Jackie Dobinson, DVM Stettler Veterinary Clinic PH (403)742-3338



# *LIMOUSIN DIVISION*

*Offering Elite Limousin Genetics*







## **Are you looking for calving ease? Check out our calving scores on each bull!**

**Calving Rating or CR:** We have taken into consideration our knowledge on the cow families, calving histories, birth weight, and phenotypical shape as a baby calf to help you better select a herd bull based on your calving needs. These numbers are not calculated; they are an estimate based on how we ourselves would use the bull if we were breeding our own cows. \*All Bulls are guaranteed to calve easy on cows\*

3 = Could be safely used on heifers.

2 = May be used on heifers with a family history of calving ease. Could be used safely on all cows.

1 = Can be used safely on all cows.







## **Richmond Docility Rating or DOC:**

This docility rating has been established to help you determine the temperament and manageability of the bulls. We as breeders strive to hold our livestock to a high standard and that includes docility. In our program, we do not tolerate any problem animals and feel you should not either. No one knows these cattle better than us and throughout the calendar year these bulls have been sorted, processed, handled numerous times, and are strictly culled to remove any behavioural problems. Below is an index defining the different categories we have decided upon. These are simply our ratings and cannot be compared to other breeders or numbering systems.

**The individual ratings on the bulls have been formed after each bull has been handled alone.**

1 = Pets – These cattle are exactly that, pets. They can be scratched in the pen and handled at all times.

2 = Calm – These cattle are very quiet, easy to handle when isolated. They do not frighten when you are working them, they are easily approached but you cannot get close enough in the pen to scratch them.

3 = Average – These cattle are calm in the group; you can walk through them without disruption. When sorting these cattle, they are easy to stop and hold, but can get uneasy and impatient when worked alone.

4 = Restless – these cattle are the ones at the back of the group in the pen; they do not disrupt the rest of the pen; they are manageable in a group but become agitated and nervous when isolated or worked alone.

5 = Nervous – these cattle are constantly moving away from you in the pen, can disrupt the group, and needs to be managed with a buddy. These cattle are hard to stop when sorting and become easily agitated if alone.

6 = Heads Up – even in a group these cattle have a big flight zone. They will be the first to run away, should be handled with a buddy and cannot be stopped or isolated when sorting in an alley. These cattle can become aggressive and are culled from our herd.







**SRD 102F**

## Richmond Fantom

Apr 15/2018 95% CPM4096031

**RS**

Homo Polled	
BW	85
TM	41
Mature Wt	
2400	
AWW 205 Wt	
673	
# of Progeny	
88	
Avg BW	
88	
Avg AWW 205	
646	

Richmond Zodiac SRD 29Z  
**Richmond Crusader SRD 53C**  
 Richmond Zandy SRD 49D

Richmond Blackout SRD 10B  
**Richmond Blush SRD 93D**  
 Richmond Blush SRD 178B



**SRD 222F**

## Richmond Firebird

May 3/2018 93% CPM4096154

**RS**

Hetero Polled	
BW	77
TM	40
Mature Wt	
2500	
AWW 205 Wt	
672	
# of Progeny	
23	
Avg BW	
85	
Avg AWW 205	
639	

Richmond Wyatt SRD 48W  
**Richmond Zodiac SRD 29Z**  
 Richmond Xotic SRD 6X

WULFS Yellowjacket K687Y  
**Richmond Aquamarine SRD 148A**  
 Richmond SRD 97U



**SRD 90F**

## Richmond Ferdinand

Apr 14/2018 95% CPM4096025

**RS**

Homo Polled	
BW	80
TM	40
Mature Wt	
2400	
AWW 205 Wt	
637	
# of Progeny	
36	
Avg BW	
89	
Avg AWW 205	
669	

Richmond X-Celler SRD 137X  
**Richmond Grand Duke SRD 8D**  
 Richmond Zeta-Jones SRD 10Z

Richmond SIR J.R SRD 128S  
**Richmond Whimsical SRD 204W**  
 CL Pennie





# Branded for Success

## Richmond General

Feb 19/2019 93% CPM4099201

Homo Polled	
BW	96
TM	38
Mature Wt	2400
AWW 205 Wt	852
# of Progeny	33
Avg BW	86
Avg AWW 205	634

# RS

Richmond Zodiac SRD 29Z  
**Richmond Crusader SRD 53C**  
 Richmond Zandy SRD 49Z  
  
 Ivy's Marksman HTZ 10Z  
**Richmond Baccardi Girl SRD 45B**  
 Richmond Tina SRD 93T



**SRD 45G**

## Richmond Grand Duke

Jan 12/2016 94% CPM4083579

Homo Polled	
BW	100
TM	45
Mature Wt	2750
AWW 205 Wt	782
# of Progeny	154
Avg BW	87
Avg AWW 205	637

# RS

Nordal Trendsetter  
**Richmond X-Celler SRD 137X**  
 Richmond SRD 181T  
  
 WULFS Waldo T928W  
**Richmond Zeta-Jones SRD 10Z**  
 RPY Perfect Storm 10R



**SRD 8D**



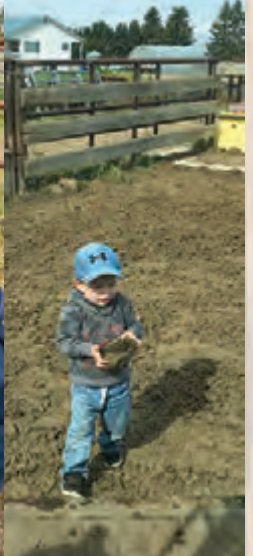



## RPY Paynes RedMan

Jan 1/2019 92% CPM4099916

Homo Polled	
BW	82
TM	39
Mature Wt	2400
AWW 205 Wt	N/A
# of Progeny	67
Avg BW	79
Avg AWW 205	605

# RS

Cole Architect 08A  
**RPY Paynes Cracker 17E**  
 EDW Beach Body  
  
 Anchor B "The Boss"  
**Anchor B Cassidy 10C**  
 Anchor B Sheridan



**RPY 1G**

## Excel Pld Fenway

Jan 16/2018 92% CPM4093636

Homo Polled	
BW	66
TM	38
Mature Wt	2150
AWW 205 Wt	740
# of Progeny	17
Avg BW	75
Avg AWW 205	577

# RS

ROMN Justice  
**Greenwood PLD XTRA Charge**  
 Greenwood PLD Rebecca  
  
 Stoneyview Zorton  
**Excel Poll Dannys Girl 630D**  
 Excel Polled Zuri



**XLR 6F**

## Red Six Mile Reckoning

Mar 10/2017 SIXM 178E 1995146

Red Angus	
BW	90
TM	44
Mature Wt	2200
AWW 205 Wt	710
# of Progeny	81
Avg BW	81
Avg AWW 205	630

# RS

Red U-2 Recon 192Y  
**Red U-2 Reckoning 149A**  
 Red U-2 Anexa 271Y  
  
 Peak Dot Eliminator 100Z  
**Red Six Mile Dixie 546C**  
 Red Sunberry Indeed 20Y



**SIXM 178E**



April 13/2021  
CPM4112088 96%

## Richmond Ferdinand SRD 66J

1



Hetero Polled	
PV	
BW	94
CR	1
DOC	2
Age of Dam 6	
AWW 205 Wt 640	
Jan 1 Wt. 1760	
GOG	3.73
ADG	3.10

Richmond Ferdinand SRD 90F

Richmond Zodiac SRD 29Z  
Richmond Catalyst SRD 110C  
Richmond Rosy SRD 139R



April 25/2021  
CPM4112139 95%

## Richmond Ferdinand SRD 153J

2



Hetero Polled	
PV	
BW	95
CR	1
DOC	3
Age of Dam 6	
AWW 205 Wt 693	
Jan 1 Wt. 1670	
GOG	3.73
ADG	2.62

Richmond Ferdinand SRD 90F

Richmond Zodiac SRD 29Z  
Richmond C.C SRD 191C  
Richmond Wishbone SRD 69W





3

# Richmond Ferdinand SRD 147J

April 25/2021

96%

CPM4112135

Homo Polled	
PV	
BW	90
CR	1
DOC	3
Age of Dam	
10	
AWW 205 Wt	
734	
Jan 1 Wt.	
1750	
GOG	3.92
ADG	4.17



**Richmond Ferdinand SRD 90F**

RPY Paynes Marathon 47U  
**Richmond Young SRD 188Y**  
 Richmond Pleasure SRD 117P

4

# Richmond Ferdinand SRD 184J

April 29/2021

95%

CPM4112155

Hetero Polled	
PV	
BW	92
CR	1
DOC	4
Age of Dam	
5	
AWW 205 Wt	
718	
Jan 1 Wt.	
1695	
GOG	3.21
ADG	3.51



**Richmond Ferdinand SRD 90F**

You're Cool NSC 3Y  
**Richmond Dafodil SRD 212D**  
 Richmond Yoga SRD 140Y



April 18/2021

CPM4112103 95%

## Richmond Jumanji SRD 102J

5



Homo Polled	
PV	
BW	90
CR	1
DOC	2
Age of Dam	
6	
AWW 205 Wt	
726	
Jan 1 Wt.	
1730	
GOG	2.65
ADG	4.35

Richmond Firebird SRD 222F

Richmond X-Cellar SRD 137X

Richmond Collectable SRD 205C

Richmond Winnie SRD 209W

May 3/2021

CPM4112180 95%

## Richmond Firebird SRD 225J

6



Homo Polled	
PV	
BW	85
CR	2
DOC	2
Age of Dam	
4	
AWW 205 Wt	
644	
Jan 1 Wt.	
1510	
GOG	3.25
ADG	3.27

Richmond Firebird SRD 222F

You're Cool NSC 3Y  
Richmond Ever After SRD 116E  
Richmond SRD 121W



Grand Dam



7

**Richmond Firebird SRD 62J****Apr 12/21 94% CPM4112085**Homo  
Polled

PV

BW 90

CR 2

DOC 2

Age of Dam  
12AWW 205 Wt  
595Jan 1 Wt.  
1560

GOG 3.02

ADG 3.63

**Richmond Firebird SRD 222F**Richmond Sir. JR. SRD 128S  
**Richmond PerfectWish SRD 60W**  
RPY Perfect Storm 10R

8

**Richmond Firebird SRD 199J****May 1/21 90% CPM4112163**Heteo  
Polled

PV

BW 100

CR 1

DOC 2

Age of Dam  
9AWW 205 Wt  
671Jan 1 Wt.  
1690

GOG 2.50

ADG 4.23

**Richmond Firebird SRD 222F**Greenwood Pld Xtra Charge  
**Murphy's 13Z**  
Murphy's 38W

9

**Richmond Firebird SRD 148J****Apr 25/21 94% CPM4112136**

Horned

PV

BW 95

CR 1

DOC 2

Age of Dam  
3AWW 205 Wt  
755Jan 1 Wt.  
1615

GOG 3.43

ADG 3.27

**Richmond Firebird SRD 222F**Richmond Ace TSR 39A  
**Ken-Doc Fancy Lady 5F**  
Ken-Doc Courtney 2C**5F is Cole's first cow!****Cole's First Bull!**



April 29/2021

CXM4112154 70%

# Richmond Firebird SRD 183J

10



Hetero Polled	
PV	
BW	100
CR	1
DOC	2
Age of Dam	
5	
AWW 205 Wt	
717	
Jan 1 Wt.	
1800	
GOG	3.21
ADG	4.64

Richmond Firebird SRD 222F

Red Bar-EL Anthem 46A  
Richmond Destiny SRD 155D  
Richmond Zinger SRD 116Z

Grand Dam

April 29/2021

CXM4112158 82%

# Richmond Firebird SRD 190J

11



Homo Polled	
SV	
BW	100
CR	1
DOC	2
Age of Dam	
5	
AWW 205 Wt	
781	
Jan 1 Wt.	
1720	
GOG	3.28
ADG	4.05

Richmond Firebird SRD 222F

Richmond X-Cellar SRD 137X  
Richmond Yasmin SRD 232D  
Richmond Yasmin SRD 101Y



**Richmond Firebird SRD 222F**

You're Cool NSC 3Y

**Richmond Amazing Grace SRD 119A**

Richmond Wisdom SRD 121W

**Grand Dam****SS** Used SRD 49J to breed our Richmond Ranch heifers.





## Richmond Jedi SRD 112J

Apr 20/21 94% CPM4112111

RPY Paynes Redman 1G

Richmond Chance SRD 72C  
 Richmond EyeShadow SRD 254E  
 Richmond Carly SRD 29C

**SS** Used to breed heifers.

# 13

Homo Polled	
PV	
BW	80
CR	2
DOC	2
Age of Dam	
4	
AWW 205 Wt	
674	
Jan 1 Wt.	
1660	
GOG	3.13
ADG	4.05



## Richmond Fantom SRD 171J

Apr 28/21 98% CPM4112147

Richmond Fantom SRD 102F

Gldn View Kruggerand  
 Richmond Yellow SRD 110Y  
 Richmond Credit SRD 27C

# 14

Polled	
N/A	
BW	95
CR	1
DOC	3
Age of Dam	
10	
AWW 205 Wt	
561	
Jan 1 Wt.	
1525	
GOG	3.36
ADG	3.27





**RPY Paynes Redman 1G**

Richmond Zodiac SRD 29Z

**Richmond Aquamarine SRD 198D**

Richmond Aquamarine SRD 148A

**Grand Dam****SS** We used SRD 173J to breed our Richmond Ranch heifers.**Dam**





**Richmond Fantom SRD 261J**

**May 13/21 94% CPM4112196**

**Richmond Fantom SRD 102F**

WULFS Waldo T928W  
**Richmond Zippy SRD 128Z**  
 Richmond Mom SRD 192M



**16**

Scurred	
PV	
BW	85
CR	1
DOC	2
Age of Dam	
9	
AWW 205 Wt	
729	
Jan 1 Wt.	
1650	
GOG	3.28
ADG	2.74



**Richmond Fantom SRD 67J**

**Apr 13/21 96% CPM4112089**

**Richmond Fantom SRD 102F**

WULFS Waldo T928W  
**Richmond Young Love SRD 109Y**  
 Richmond Sherea SRD 108S

**17**

Scurred	
PV	
BW	100
CR	1
DOC	3
Age of Dam	
10	
AWW 205 Wt	
710	
Jan 1 Wt.	
1710	
GOG	3.21
ADG	3.69



**Richmond Fantom SRD 194J**

**Apr 30/21 72% CXM4112161**

**Richmond Fantom SRD 102F**

Riverside Net Worth 2Y  
**Richmond Amanda SRD 173A**  
 Richmond SRD 133U

**18**

Homo Polled	
SV	
BW	100
CR	1
DOC	4
Age of Dam	
8	
AWW 205 Wt	
708	
Jan 1 Wt.	
1740	
GOG	3.47
ADG	3.27



19

## Richmond Johnny Cash SRD 137J

April 24/2021

96% CPM4112126

Homo Polled	
PV	
BW	90
CR	1
DOC	2
Age of Dam	
5	
AWW 205 Wt	
769	
Jan 1 Wt.	
1685	
GOG	2.91
ADG	3.87



Richmond Fantom SRD 102F

You're Cool NSC 3Y  
 Richmond Delight SRD 81D  
 Richmond Miss SRD 123Z



Grand Dam

20

## Richmond Fantom SRD 180J

April 28/2021

95% CPM4112152

Homo Polled	
PV	
BW	85
CR	1
DOC	2
Age of Dam	
3	
AWW 205 Wt	
595	
Jan 1 Wt.	
1560	
GOG	2.91
ADG	3.93



Richmond Fantom SRD 102F

Lakeroad Belvin  
 Richmond Felena SRD 183F  
 Richmond Brandi SRD 194B



April 24/2021

CPM4112131 95%

## Richmond Fantom SRD 142J

# 21



Homo Polled	
SV +	
BW	85
CR	1
DOC	2
Age of Dam	
3	
AWW 205 Wt	
697	
Jan 1 Wt.	
1620	
GOG	3.36
ADG	3.21

Richmond Fantom SRD 102F

Lakeroad Belvin

Richmond Firefly SRD 207F

Richmond Xcelyn SRD 165X

April 21/2021

CXM4112112 70%

## Richmond Fantom SRD 116J

# 22



Scurred	
PV	
BW	85
CR	1
DOC	3
Age of Dam	
6	
AWW 205 Wt	
720	
Jan 1 Wt.	
1700	
GOG	2.84
ADG	3.69

Richmond Fantom SRD 102F

WULFS Yellowjacket K687Y

Richmond Cherry Pie SRD 117C

701X





**23****Richmond Fantom SRD 256J****May 12/21 94% CPM4112193**

Homo Polled	
PV	
BW	92
CR	1
DOC	3
Age of Dam	
3	
AWW 205 Wt	
634	
Jan 1 Wt.	
1510	
GOG	2.80
ADG	3.69

**Richmond Fantom SRD 102F**

Diamond C Chapplin

**Richmond Flynn Solo SRD 244F**

Richmond Yushania SRD 84Y

**24****Richmond Fantom SRD 172J****Apr 28/21 94% CPM4112148**

Homo Polled	
SV	
BW	85
CR	1
DOC	3
Age of Dam	
10	
AWW 205 Wt	
593	
Jan 1 Wt.	
1490	
GOG	2.16
ADG	4.11

**Richmond Fantom SRD 102F**

Anchor B Great West

**Richmond You Go Girl SRD 3Y**

Carpenters Shanti

**25****Richmond Fantom SRD 217J****May 2/21 95% CPM4112174**

Homo Polled	
PV	
BW	90
CR	1
DOC	2
Age of Dam	
10	
AWW 205 Wt	
620	
Jan 1 Wt.	
1520	
GOG	3.28
ADG	3.10

**Richmond Fantom SRD 102F**

Anchor B Great West

**Richmond Yushania SRD 84Y**

Richmond Rebecca SRD 94R

**Grand Dam**





## Richmond Fenway SRD 53J

Apr 10/21 94% CPM4112080

Excel Pld Fenway

Richmond Crusader SRD 53C  
**Richmond Everlastin SRD 242E**  
 Richmond SRD 204W

# 26

Homo Polled	
PV	
BW	85
CR	3
DOC	2
Age of Dam	
4	
AWW 205 Wt	
593	
Jan 1 Wt.	
1570	
GOG	3.66
ADG	3.51



## Richmond Fenway SRD 111J

Apr 20/21 93% CPM4112100

Excel Pld Fenway

Richmond Zodiac SRD 29Z  
**Richmond Game Point SRD 227G**  
 Richmond Athena SRD 88A

# 27

Homo Polled	
PV	
BW	60
CR	3
DOC	3
Age of Dam	
2	
AWW 205 Wt	
585	
Jan 1 Wt.	
1430	
GOG	2.95
ADG	3.63



## Richmond Fenway SRD 175J

Apr 28/21 88% CXM4112150

Excel Pld Fenway

Richmond Zodiac SRD 29Z  
**Richmond Gold Rose SRD 216G**  
 Richmond Yasmin SRD 232D

# 28

Homo Polled	
PV	
BW	75
CR	3
DOC	2
Age of Dam	
2	
AWW 205 Wt	
608	
Jan 1 Wt.	
1460	
GOG	2.72
ADG	4.17



**29****Richmond JohnDutton SRD 47J****Apr 8/21 94% CPM4112077**

Homo Polled	
PV	
BW	55
CR	3
DOC	2
Age of Dam	
2	
AWW 205 Wt	
545	
Jan 1 Wt.	
1550	
GOG	3.54
ADG	3.87

**Excel Pld Fenway**

Richmond El Dorado SRD 114E  
**Richmond Gin SRD 66G**  
 Richmond Ernest SRD 196E

**30****Richmond Fenway SRD 216J****May 1/21 94% CPM4112173**

Homo Polled	
PV	
BW	75
CR	3
DOC	2
Age of Dam	
2	
AWW 205 Wt	
590	
Jan 1 Wt.	
1400	
GOG	2.80
ADG	3.39

**Excel Pld Fenway**

Richmond Draft Pick SRD 74D  
**Richmond Gem SRD 51G**  
 Richmond Enchant SRD 161E

**31****Richmond Fenway SRD 218J****May 2/21 94% CPM4112175**

Homo Polled	
PV	
BW	70
CR	3
DOC	3
Age of Dam	
2	
AWW 205 Wt	
595	
Jan 1 Wt.	
1490	
GOG	3.47
ADG	3.87

**Excel Pld Fenway**

Richmond Draft Pick SRD 74D  
**Richmond Grace SRD 130G**  
 Richmond Edna SRD 179E







## Richmond Draft Pick SRD 222J

May 2/21 93% CPM4112177

Richmond Draft Pick SRD 157G

Sirloin Xtractor 175E

Richmond GummyBear SRD 183G

Richmond Miss SRD 94U

# 32

Homo Polled	
SV	
BW	80
CR	3
DOC	2
Age of Dam	
2	
AWW 205 Wt	
652	
Jan 1 Wt.	
1440	
GOG	2.80
ADG	3.51



Grand Dam



## Richmond Reckoning SRD 232J

May 4/21 48% CXM4112170

Red Six Mile Reckoning 178E

Richmond Chief SRD 189C

Richmond Evenlymade SRD 175E

Richmond Companion SRD 141C

# 33

Homo Polled	
SV	
BW	88
CR	1
DOC	5
Age of Dam	
4	
AWW 205 Wt	
712	
Jan 1 Wt.	
1620	
GOG	3.28
ADG	3.10



## Richmond Reckoning SRD 201J

May 1/21 47% CXM4112165

Red Six Mile Reckoning 178E

Richmond Grand Duke SRD 8D

Richmond Fabulous SRD 39F

Richmond Camera Shy SRD 7C

# 34

Scurred	
SV	
BW	85
CR	1
DOC	2
Age of Dam	
3	
AWW 205 Wt	
738	
Jan 1 Wt.	
1650	
GOG	2.43
ADG	3.87



Grand Dam







May 28/2021

CPM4112210 93%

## Richmond Duke SRD 282J

36



**Richmond Grand Duke SRD 8D**

Richmond Zodiac SRD 29Z  
**Richmond Exception SRD 265E**  
Richmond Adelle SRD 107A

Homo Polled	
PV	
BW	90
CR	1
DOC	2
Age of Dam	
4	
AWW 205 Wt	
636	
Jan 1 Wt.	
1460	
GOG	3.17
ADG	3.57



**Grand Dam**

May 18/2021

CPM4112200 93%

## Richmond Duke SRD 268J

37



**Richmond Grand Duke SRD 8D**

Richmond Zodiac SRD 29Z  
**Richmond FancyMover SRD 171F**  
Richmond Adelle SRD 107A

Homo Polled	
PV	
BW	92
CR	1
DOC	3
Age of Dam	
3	
AWW 205 Wt	
697	
Jan 1 Wt.	
1590	
GOG	3.02
ADG	3.39



**Grand Dam**



**38****Richmond Duke SRD 252J****May 10/21 95% CPM4112190**Homo  
Polled

PV

BW 94

CR 1

DOC 2

Age of Dam  
4AWW 205 Wt  
622Jan 1 Wt.  
1530

GOG 3.51

ADG 3.57

**Richmond Grand Duke SRD 8D**

Richmond Zodiac SRD 29Z

**Richmond Elroy SRD 207E**

Richmond SRD 65U

**39****Richmond Duke SRD 277J****May 23/21 94% CPM4112206**Hetero  
Polled

PV

BW 90

CR 1

DOC 4

Age of Dam  
3AWW 205 Wt  
728Jan 1 Wt.  
1530

GOG 2.99

ADG 3.93

**Richmond Grand Duke SRD 8D**

Richmond Zodiac SRD 29Z

**Richmond Fancy SRD 81F**

Richmond Zandy SRD 151Z

**40****Richmond Duke SRD 224J****May 3/21 95% CPM4112179**Homo  
Polled

PV

BW 85

CR 1

DOC 2

Age of Dam  
4AWW 205 Wt  
733Jan 1 Wt.  
1585

GOG 2.99

ADG 3.57

**Richmond Grand Duke SRD 8D**

You're Cool NSC 3Y

**Richmond Encanto SRD 240E**

Richmond SRD 176Z







**Richmond Ferdinand SRD 226J**

**May 3/21 94% CPM4112181**

**Richmond Ferdinand SRD 90F**

WULFS Yellowjacket K687Y  
**Richmond Beyonce SRD 159B**  
 Richmond SRD 115X



**Grand Dam**

**41**

Hetero Polled	
PV	
BW	90
CR	1
DOC	2
Age of Dam	7
AWW 205 Wt	703
Jan 1 Wt.	1670
GOG	3.43
ADG	3.69



**Richmond Ferdinand SRD 46J**

**Apr 8/21 96% CPM4112076**

**Richmond Ferdinand SRD 90F**

Richmond Zodiac SRD 29Z  
**Richmond Footloose SRD 144F**  
 Richmond Xact SRD 40X

**42**

Homo Polled	
PV	
BW	70
CR	2
DOC	3
Age of Dam	3
AWW 205 Wt	626
Jan 1 Wt.	1540
GOG	3.28
ADG	2.62





**43****NEM John Hancock 263J**

May 15/2021

93%

CPM4111441

Homo Polled	
PV	
BW	90
CR	1
DOC	2
Age of Dam	
4	
AWW 205 Wt	
656	
Jan 1 Wt.	
1560	
GOG	3.10
ADG	3.51

**Richmond General SRD 45G**

Edwards Colossal  
**EDW Extacy 522E**  
 EDW Zola

**44****NEM Jack Frost 150J**

April 25/2021

94%

CPM4111432

Homo Polled	
PV	
BW	87
CR	1
DOC	2
Age of Dam	
4	
AWW 205 Wt	
679	
Jan 1 Wt.	
1620	
GOG	2.99
ADG	3.81

**Richmond General SRD 45G**

Richmond Ace TSR 39A  
**Ken-Doc Exquisite KGS 6E**  
 Ken-Doc Zera





## NEM Jeremiah 80J

Apr 15/21 94% CPM4111433

**Richmond General SRD 45G**

Ken-Doc Lover Boy  
**Ken-Doc Christin KGS 7C**  
 Ken-Doc Shannon



# 45

Homo	
Polled	
PV	
BW	92
CR	1
DOC	2
Age of Dam	6
AWW 205 Wt	741
Jan 1 Wt.	1645
GOG	3.28
ADG	2.92



## NEM Joy Ride 186J

Apr 29/21 94% CPM4111440

**Richmond General SRD 45G**

Richmond Xecutive SRD 74X  
**Ken-Doc Corrina KGS 28C**  
 Ken-Doc Wine & Roses



# 46

Homo	
Polled	
PV	
BW	90
CR	1
DOC	2
Age of Dam	6
AWW 205 Wt	609
Jan 1 Wt.	1460
GOG	3.02
ADG	2.68



## NEM Jackpot 157J

Apr 26/21 94% CPM4111438

**Richmond General SRD 45G**

Richmond Ace TSR 39A  
**Ken-Doc Georgina KGS 13G**  
 Ken-Doc Barbie

# 47

Hetero	
Polled	
PV	
BW	80
CR	1
DOC	2
Age of Dam	2
AWW 205 Wt	680
Jan 1 Wt.	1425
GOG	2.61
ADG	3.39



**48****NEM Jesse James 92J****Apr 17/21 93% CPM4111435**Homo  
Polled**Richmond General SRD 45G**

PV

Qually-T Captain America  
**Qually-T Frutopia 8F**  
 Qually-T Utha

BW 75

CR 2

DOC 2

Age of Dam  
3AWW 205 Wt  
662Jan 1 Wt.  
1565

GOG 3.06

ADG 3.04

**49****NEM Jack Daniels 197J****Apr 30/21 94% CPM4111437**Hetero  
Polled**Richmond General SRD 45G**

PV

Richmond Ace TSR 39A  
**Ken-Doc Empress KGS 11E**  
 Ken-Doc Xpose

BW 95

CR 1

DOC 2

Age of Dam  
4AWW 205 Wt  
688Jan 1 Wt.  
1625

GOG 3.47

ADG 3.57

**Grand Dam****50****NEM Justice 164J****Apr 26/21 94% CPM4111439**Homo  
Polled**Richmond General SRD 45G**

PV

Richmond Ace TSR 39A  
**Ken-Doc Elsie KGS 18E**  
 Ken-Doc Penny

BW 83

CR 1

DOC 3

Age of Dam  
4AWW 205 Wt  
627Jan 1 Wt.  
1430

GOG 2.46

ADG 2.62







## NEM King Kong 32K

Feb 2/22 94% CPM4115813

**Richmond General SRD 45G**

Richmond Doc Holiday SRD 101D  
**Ken-Doc Gracie KGS 29G**  
 Ken-Doc 34Z

# 51

Homo	
Polled	
PV	
BW	97
CR	1
DOC	2
Age of Dam	3
AWW 205 Wt	770
Jan 1 Wt.	1135
ADG	3.05



## NEM Knight 24K

Jan 22/22 94% CPM4115810

**Richmond General SRD 45G**

Richmond Ace TSR 39A  
**Ken-Doc Daphne KGS 13D**  
 Ken-Doc Penny

# 52

Homo	
Polled	
PV	
BW	105
CR	1
DOC	2
Age of Dam	6
AWW 205 Wt	768
Jan 1 Wt.	1260
ADG	3.68



## NEM Kobe Bryant 28K

Jan 26/22 94% CPM4115823

**Richmond General SRD 45G**

Richmond Doc Holiday SRD 101D  
**Ken-Doc Giselle KGS 21G**  
 Ken-Doc Angel

# 53

Homo	
Polled	
PV	
BW	80
CR	3
DOC	3
Age of Dam	3
AWW 205 Wt	653
Jan 1 Wt.	1020
ADG	2.99





**54****NEM Knox 1K ET****Jan 1/22 94% CPM4115814**

Scurred

**Richmond Fantom SRD 102F**

PV

BW 73

CR 2

DOC 2

Age of Dam

n/a

AWW 205 Wt

707

Jan 1 Wt.

1230

ADG 3.33

**55****NEM Kade 27K****Jan 24/22 95% CPM4115885**Homo  
Polled**Richmond Fantom SRD 102F**

PV

BW 96

CR 1

DOC 2

Age of Dam

7

AWW 205 Wt

745

Jan 1 Wt.

1190

ADG 3.22

**Grand Dam****56****NEM Keanu Reeves 4K ET****Jan 2/22 93% CPM4115817**Homo  
PolledHLC DBCC Flatliner 05F  
**DBCC Hard Pressed 9H**  
Miss Hew Connie

PV

BW 83

CR 2

DOC 2

Age of Dam

n/a

AWW 205 Wt

617

Jan 1 Wt.

1100

ADG 3.22





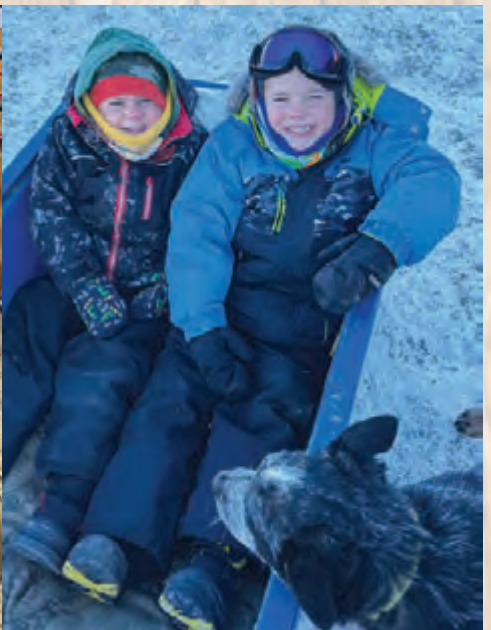









## **Richmond Docility Rating or DOC:**

This docility rating has been established to help you determine the temperament and manageability of the bulls. We as breeders strive to hold our livestock to a high standard and that includes docility. In our program, we do not tolerate any problem animals and feel you should not either. No one knows these cattle better than us and throughout the calendar year these bulls have been sorted, processed, handled numerous times, and are strictly culled to remove any behavioural problems. Below is an index defining the different categories we have decided upon. These are simply our ratings and cannot be compared to other breeders or numbering systems.

**The individual ratings on the bulls have been formed after each bull has been handled alone.**

1 = Pets – These cattle are exactly that, pets. They can be scratched in the pen and handled at all times.

2 = Calm – These cattle are very quiet, easy to handle when isolated. They do not frighten when you are working them, they are easily approached but you cannot get close enough in the pen to scratch them.

3 = Average – These cattle are calm in the group; you can walk through them without disruption. When sorting these cattle, they are easy to stop and hold, but can get uneasy and impatient when worked alone.

4 = Restless – these cattle are the ones at the back of the group in the pen; they do not disrupt the rest of the pen; they are manageable in a group but become agitated and nervous when isolated or worked alone.

5 = Nervous – these cattle are constantly moving away from you in the pen, can disrupt the group, and needs to be managed with a buddy. These cattle are hard to stop when sorting and become easily agitated if alone.

6 = Heads Up – even in a group these cattle have a big flight zone. They will be the first to run away, should be handled with a buddy and cannot be stopped or isolated when sorting in an alley. These cattle can become aggressive and are culled from our herd.



# ***ANGUS DIVISION***

***Offering Elite Black Angus &  
Red Angus Genetics***







## Are you looking for calving ease? Check out our calving scores on each bull!

**Calving Rating or CR:** We have taken into consideration our knowledge on the cow families, calving histories, birth weight, and phenotypical shape as a baby calf to help you better select a herd bull based on your calving needs. These numbers are not calculated; they are an estimate based on how we ourselves would use the bull if we were breeding our own cows. \*All Bulls are guaranteed to calve easy on cows\*

3 = Could be safely used on heifers.

2 = May be used on heifers with a family history of calving ease. Could be used safely on all cows.

1 = Can be used safely on all cows.





### **Producing Cattle that GAIN on GRASS.**

The 2023 bull pen gained over 3 lbs. on grass

We are very proud of this offering. The purebred cattle here at Richmond Ranch are raised ranch style and calved out the way you calve, so the cattle will excel in ranch conditions. The do it themselves ranch cows stay out on native grass until late fall when the calves are weaned off. The calves are wintered in a 20-acre pen on a combination of quality forages ensiled to get them through the winter and back on Grass. This program is designed to develop cattle for longevity and success in any program. We have always selected cattle that thrive on grass, selecting powerful herd sires that stick to the basics of beef, thick and naturally fleshing. This past May 27th we took a weight on our sale bulls just before we sent them to grass. We brought them back home on Oct 8th for a weight off pasture. They went back to the pasture but were supplemented as grass was becoming dormant.

The Bulls came back to the yard Nov 12th for the winter to get ready for the sale.

We calculated the Gain on Grass from the May 27th weight and the Oct 8th weight. Over the 134 days the whole pen averaged 3.29 lbs. per day – (The Cheapest gain we can get!)

We have entered this data on each sale lot under “GOG” Gain on Grass.

We also calculated their Average Daily Gain from Oct 8th to their Jan 1st weight.

Over the 84 days the whole pen averaged 3.46 lbs. /day

We have entered this data on each lot under “ADG” Average Daily Gain.

**When pounds and profits matter, choose your next herd bull from quality genetics.**







## Peak Dot Attractive

Jan 13/2018 PDAR 186F 2029235

**RS**

Black Angus	
BW	76
TM	43
Mature Wt	
2500	
AWW 205 Wt	
797	
# of Progeny	
162	
Avg BW	
78	
Avg AWW 205	
657	

JMB Traction 292  
**Schiefelbein Attractive 4565**  
 Frosty Answer 3979

Vision Unanimous 1418  
**Peak Dot Erica 709B**  
 Erica of Peak Dot 752Z



## Peak Dot No Doubt

Jan 15/2018 PDAR 197F 2023948

**RS**

Black Angus	
BW	74
TM	43
Mature Wt	
2100	
AWW 205 Wt	
809	
# of Progeny	
29	
Avg BW	
74	
Avg AWW 205	
593	

MOGCK Bullseye  
**Hoover No Doubt**  
 Miss Blackcap Ellston J2

Peak Dot Epic 1069X  
**Peak Dot Lady 114A**  
 Lady of Peak Dot 415Y





## Cockburn Patriot 9048

Feb 14/19 CWJ 48G 2120393

Red Angus	
BW	90
TM	43
Mature Wt	
2500	
AWW 205 Wt	
648	
# of Progeny	
136	
Avg BW	
83	
Avg AWW 205	
673	

# RS

Red Flying K Patriot 16B  
**Red T-S Patriot 84K**  
 Red CFRA Beefsteak 5F

Red Bar E-L Ribeye 103R  
**Red Cockburn Cora 137Y**  
 Red Wilbar Cora 443P



## Red SSS Moxy

Feb 2/20 DBB 32H 2187542

Red Angus	
BW	83
TM	44
Mature Wt	
2300	
AWW 205 Wt	
646	
# of Progeny	
31	
Avg BW	
79	
Avg AWW 205	
667	

# RS

Red SSS Contendor 121B  
**Red SSS Grit 5F**  
 Red SSS Scaara 382Z

Red SSS Soldier 365W  
**Red SSS Rebello 368Z**  
 SSS Rebello 623X



## Red Richmond Cowboy

Apr 18/19 SRD 122G 2128319

Red Angus	
BW	76
TM	40
Mature Wt	
2200	
AWW 205 Wt	
796	
# of Progeny	
6	
Avg BW	
71	
Avg AWW 205	
606	

# RS

Red Pie The Cowboy Kind 343  
**Red Cockburn Cowboy Kind 635D**  
 Red Cockburn Cora 140Y

Red Bar E-L Anthem 46A  
**Red Richmond Emily SRD 94E**  
 Red Piro Melte 344A







PV	
BW	77
CR	2
DOC	2
Age of Dam	
3	
AWW 205 Wt	
658	
Jan 15 Wt.	
1735	
GOG	3.77
ADG	2.98



Grand Dam

**Peak Dot Attractive 186F**  
  
Richmond Defiance SRD 246D  
**Richmond Fate SRD 152F**  
Richmond Defy Fate SRD 2D





**58****Richmond Attractive SRD 206J**May 1/2021  
2234904

PV	
BW	98
CR	1
DOC	2
Age of Dam	
3	
AWW 205 Wt	
810	
Jan 15 Wt.	
1760	
GOG	3.99
ADG	2.68

**Peak Dot Attractive 186F**

Young Dale Believe 46B  
**Richmond Lass SRD 251F**  
 Galten Lass 119C

**59****Richmond Attractive SRD 136J**April 23/2021  
2234892

PV	
BW	89
CR	1
DOC	3
Age of Dam	
4	
AWW 205 Wt	
677	
Jan 15 Wt.	
1660	
GOG	3.47
ADG	2.74

**Peak Dot Attractive 186F**

Young Dale Believe 46B  
**Richmond Black Beauty SRD 234E**  
 Richmond Black Beauty SRD 116B

**Grand Dam**



May 27/2021  
2234923

## Richmond Attractive SRD 280J

60



PV	
BW	80
CR	2
DOC	3
Age of Dam	9
AWW 205 Wt	664
Jan 15 Wt.	1560
GOG	3.88
ADG	2.74

Peak Dot Attractive 186F

Crowfoot Equation 57393R  
Crowfoot Kelton 2015Z  
Crowfoot Patti 7043T

Apr 20/2021  
2234871

## Richmond Attractive SRD 108J

61



PV	
BW	70
CR	3
DOC	2
Age of Dam	2
AWW 205 Wt	689
Jan 15 Wt.	1610
GOG	3.32
ADG	2.74

Peak Dot Attractive 186F

Richmond Defiance SRD 246D  
Richmond Tilda SRD 74G  
Richmond Tilda SRD 251E

Grand Dam



**62****Richmond Attractive SRD 196J**April 30/2021  
2234902

PV	
BW	77
CR	2
DOC	3
Age of Dam	4
AWW 205 Wt	667
Jan 15 Wt.	1710
GOG	3.77
ADG	3.27

**Peak Dot Attractive 186F**

Young Dale Believe 46B  
**Richmond Tilda SRD 251E**  
 Willabar Tilda 117W

**63****Richmond Attractive SRD 170J**April 27/2021  
2234898

PV	
BW	82
CR	1
DOC	2
Age of Dam	3
AWW 205 Wt	769
Jan 15 Wt.	1880
GOG	4.33
ADG	4.17

**Peak Dot Attractive 186F**

Young Dale Believe 46B  
**Richmond Answer SRD 70F**  
 Galten R Answer 152C



May 2/2021  
2234907

## Richmond Attractive SRD 219J

64



PV	
BW	78
CR	3
DOC	4
Age of Dam	5
AWW 205 Wt	663
Jan 15 Wt.	1660
GOG	3.62
ADG	2.80

Peak Dot Attractive 186F

Richmond Bruno SRD 77B  
Richmond Miss Effie SRD 259D  
SOO Line Effie 9135

Grand Dam

April 16/2021  
2234857

## Richmond King SRD 84J

65



PV	
BW	85
CR	2
DOC	3
Age of Dam	4
AWW 205 Wt	651
Jan 15 Wt.	1750
GOG	3.40
ADG	3.27

Peak Dot Attractive 186F

S Titlist 1145  
Richmond Queen SRD 60E  
WhiskeyLane Queen 20C



**66****Richmond Attractive****Apr 12/21 SRD 58J 2234851**

PV

BW 80

CR 2

DOC 2

Age of Dam  
2AWW 205 Wt  
635Jan 15 Wt.  
1460

GOG 3.36

ADG 2.50

**Peak Dot Attractive 186F**

Young Dale Believe 46B

**Richmond BlownAway SRD 96G**

Richmond BlownAway SRD 82B

**Grand Dam****67****Richmond Attractive****Apr 14/21 SRD 72J 2234854**

PV

BW 80

CR 3

DOC 2

Age of Dam  
3AWW 205 Wt  
631Jan 15 Wt.  
1460

GOG 3.02

ADG 2.62

**Peak Dot Attractive 186F**

HF Electric Avenue 196D

**Richmond Vixon SRD 184F**

Allandale Vixon 14C

**68****Richmond Attractive****May 3/21 SRD 230J 2234909**

PV

BW 89

CR 2

DOC 2

Age of Dam  
5AWW 205 Wt  
664Jan 15 Wt.  
1585

GOG 3.99

ADG 2.50

**Peak Dot Attractive 186F**

Young Dale Believe 46B

**Richmond Darling Lass SRD 71D**

Richmond BlackLass SRD 147B







## Richmond Attractive

Apr 4/21 SRD 43J 2234848

Peak Dot Attractive 186F

HF Decisive 56Z

Richmond Calpurnia SRD 217C

Willabar Tilda 117W



Grand Dam

# 69

PV	
BW	75
CR	3
DOC	3
Age of Dam	
6	
AWW 205 Wt	
567	
Jan 15 Wt.	
1600	
GOG	3.02
ADG	2.74



## Richmond Attractive

May 16/21 SRD 265J 2234921

Peak Dot Attractive 186F

SAV Final Answer 0035

Richmond Zelda SRD 70Z

Willabar Ina 25W



# 70

PV	
BW	89
CR	2
DOC	2
Age of Dam	
9	
AWW 205 Wt	
723	
Jan 15 Wt.	
1540	
GOG	3.73
ADG	2.38



## Richmond Attractive

Apr 29/21 SRD 189J 2234901

Peak Dot Attractive 186F

Willow Net Worth 05U

Willow Burgess 22Y

Willow Burgess R34



# 71

PV	
BW	85
CR	2
DOC	3
Age of Dam	
10	
AWW 205 Wt	
629	
Jan 15 Wt.	
1520	
GOG	3.36
ADG	2.62



**72****Richmond Attractive****May 5/21 SRD 240J 2234915**

PV

BW 60

CR 3

DOC 2

Age of Dam  
3AWW 205 Wt  
625Jan 15 Wt.  
1585

GOG 2.72

ADG 3.69

**Peak Dot Attractive 186F**

HF Electric Avenue 196D

**Richmond Charisma SRD 177F**

Richmond Charisma SRD 145C

**Grand Dam****73****Richmond Attractive****May 16/21 SRD 264J 2234919**

PV

BW 70

CR 3

DOC 2

Age of Dam  
4AWW 205 Wt  
611Jan 15 Wt.  
1460

GOG 3.25

ADG 3.57

**Peak Dot Attractive 186F**

Young Dale Believe 46B

**Richmond Blackbird SRD 82E**

XO Crowfoot Blackbird 2401Z

**Grand Dam****74****Richmond Sam Crow****Apr 17/21 SRD 90J 2273843**

PV

BW 85

CR 1

DOC 3

Age of Dam  
9AWW 205 Wt  
622Jan 15 Wt.  
1520

GOG 2.84

ADG 3.10

**Peak Dot No Doubt 197F**

Crowfoot Equation 57393R

**XO Crowfoot Blackbird 2401Z**

Crowfoot Blackbird 8089U







**Richmond No Doubt**

**Apr 17/21 SRD 93J 2234866**

**Peak Dot No Doubt 197F**

Timber Trail Road Hammered  
**Galten Lass 119C**  
Worthmore Lass 6A

**75**

SV	
BW	85
CR	1
DOC	4
Age of Dam	
6	
AWW 205 Wt	
718	
Jan 15 Wt.	
1660	
GOG	3.73
ADG	2.38



**Richmond No Doubt**

**May 2/21 SRD 221J 2234908**

**Peak Dot No Doubt 197F**

Young Dale Believe 46B  
**Ricgmond Lass SRD 198G**  
Galten Lass 119C

**76**

PV	
BW	80
CR	1
DOC	3
Age of Dam	
2	
AWW 205 Wt	
612	
Jan 15 Wt.	
1535	
GOG	3.81
ADG	2.80



**Richmond No Doubt**

**Apr 22/21 SRD 128J 2234888**

**Peak Dot No Doubt 197F**

SAV Final Answer 0035  
**Richmond BitterSweet SRD 60B**  
Richmond Zelda SRD 63Z

**77**

PV	
BW	85
CR	1
DOC	3
Age of Dam	
7	
AWW 205 Wt	
581	
Jan 15 Wt.	
1580	
GOG	3.51
ADG	2.98





**78****Richmond No Doubt****Apr 22/21 SRD 129J 2234889**

PV

BW 90

CR 1

DOC 3

Age of Dam  
6AWW 205 Wt  
685Jan 15 Wt.  
1620

GOG 3.77

ADG 2.62

**Peak Dot No Doubt 197F**Mohnen Soth Dakota 402  
**Galten Mary 34C**  
Jamesview Miss Morrison**79****Richmond No Doubt****Apr 29/21 SRD 188J 2234900**

PV

BW 80

CR 1

DOC 2

Age of Dam  
2AWW 205 Wt  
658Jan 15 Wt.  
1570

GOG 3.58

ADG 2.98

**Peak Dot No Doubt 197F**Young Dale Believe 46B  
**Richmond BlackBeauty SRD 71G**  
Richmond BlackBeauty SRD 116B**Grand Dam****80****Richmond No Doubt****May 9/21 SRD 1240J 2234916**

Pending

BW 85

CR 2

DOC 3

Age of Dam  
4AWW 205 Wt  
665Jan 15 Wt.  
1560

GOG 3.21

ADG 2.74

**Peak Dot No Doubt 197F**Young Dale Believe 46B  
**Richmond Grace SRD 70E**  
Richmond Grace SRD 40A





### **Breeding Protection Plan**

We will be offering our Breeding Protection Plan once again. Our goal is to help ensure your cows get bred and your investment is protected. We know that no matter how many precautions we take, bulls will be bulls, and injury or death is always a possibility. We still encourage that the best defense you can buy is a backup bull. One that you have selected, that stands ready in your yard. However, we understand this is not always an option for everyone and have designed our Breeding Protection Plan to better serve our valued customers.

With an additional 10% on the purchase price of your new bull \* \$500 minimum\* - The Breeding Protection Plan will give you 1 year protection against injury or death with either a replacement bull, a credit for a future bull sale, or a combination of the two. If you should have any problem with your bull – Make Richmond Ranch your first call.

Jim or Stephanie at 403-323-8433 or 403-368-2103.

Richmond Ranch will do our best to resolve any issue with honesty and integrity to keep you a satisfied and repeat customer. That is our uncompromising commitment. Under our Breeding Protection Plan your bull is protected from injury, sickness, accident, structural breakdown, or death. The Breeding Protection Plan will not protect from any injury or death due to malicious, willful intentional acts of mistreatment.

Richmond Ranch retains the right to request photos.

Richmond Ranch retains the right to request a vet report or Postmortem.

Please feel free to give us a call anytime to discuss this Breeding Protection Plan.





# *Custom Corn Planting & Silaging*

Call to book your spot in the 2023 season.

Brandon - 403 741 2675







## Richmond Attractive

Aug 30/21 SRD 285J 2290779

Peak Dot Attractive 186F

Red SIXM Django 258D  
Red Richmond April SRD 42F  
Red Lauron April 176C

# 81

SV +	
BW	70
CR	3
DOC	2
Age of Dam	3
AWW 205 Wt	690
Jan 15 Wt.	1370
ADG	3.58



Grand Dam



## Richmond Blast Encore

Feb 3/22 SRD 34K 2290382

PM Encore 20'17  
Blast Encore 4H  
Blast Miss Mayflower 20U

PM Journey 522  
PM Barbara 230'20  
PM Barbara 40'13

# 82

PV	
BW	83
CR	2
DOC	3
Age of Dam	2
AWW 205 Wt	761
Jan 15 Wt.	1145
ADG	3.46



## Red Richmond Moxy

Jan 23/22 SRD 26K 2290255

Red SSS Moxy 32H

Red SIXM Reckoning 178E  
Red Richmond April SRD 12H  
Red Lauron April 176C

# 83

PV	
BW	78
CR	3
DOC	2
Age of Dam	2
AWW 205 Wt	703
Jan 15 Wt.	1080
ADG	3.09



Grand Dam



**84****Red Richmond Moxy****Jan 14/22 SRD 13K 2290247**

PV

BW 60

CR 3

DOC 3

Age of Dam  
2AWW 205 Wt  
692Jan 15 Wt.  
1080

ADG 2.35

**Red SSS Moxy 32H**

Red SIXM Reckoning 178E

**Red Richmond Heiress SRD 6H**

Red Crowfoot 2109Z

**Grand Dam****85****Red Richmond Moxy****Jan 20/22 SRD 19K 2290251**

PV

BW 84

CR 2

DOC 3

Age of Dam  
3AWW 205 Wt  
729Jan 15 Wt.  
1130

ADG 2.72

**Red SSS Moxy 32H**

Red Bar E-L Anthem 46A

**Red Richmond Brandina SRD 6G**

Red Piro Brandina 304A

**86****Red Richmond Moxy****Jan 17/22 SRD 17K 2290249**

PV

BW 107

CR 1

DOC 4

Age of Dam  
3AWW 205 Wt  
763Jan 15 Wt.  
1280

ADG 3.58

**Red SSS Moxy 32H**

Red SIXM Reckoning 178E

**Red Richmond Lunar SRD 32G**

Red Bar4A Lunar Lady 62C







Red SSS Moxy 32H  
Red Shiloh Dessert Storm 22D  
Red Vikse Cresta 181F  
Red Vikse Cresta 31B

PV	
BW	76
CR	2
DOC	2
Age of Dam	
4	
AWW 205 Wt	
721	
Jan 15 Wt.	
1180	
ADG	3.21



**88****Red Richmond Moxy****Jan 17/22 SRD 15K 2290248**

PV

BW 80

CR 2

DOC 3

Age of Dam  
3AWW 205 Wt  
720Jan 15 Wt.  
1160

ADG 2.90

**Red SSS Moxy 32H**

Red Bar E-L Anthem 46A

**Red Richmond Patriot SRD 8G**

Red Piro Patriot 520C

**89****Red Richmond Moxy****Jan 18/22 SRD 18K 2290250**

PV

BW 87

CR 2

DOC 3

Age of Dam  
9AWW 205 Wt  
661Jan 15 Wt.  
1150

ADG 3.09

**Red SSS Moxy 32H**

Red Piro Mission Statement 130Y

**Red Piro Brandina 305A**

Red Piro Brandina 803U

**90****Red Richmond Moxy****Jan 22/22 SRD 25K 2290254**

PV

BW 100

CR 1

DOC 3

Age of Dam  
3AWW 205 Wt  
736Jan 15 Wt.  
1210

ADG 3.46

**Red SSS Moxy 32H**

Red SIXM Reckoning 178E

**Red Richmond Galaxy SRD 37G**

Red Crowfoot 2109Z

**Grand Dam**



April 10/2021  
2273973

## Red Richmond Patriot SRD 52J

91



PV	
BW	70
CR	2
DOC	3
Age of Dam	4
AWW 205 Wt	655
Jan 15 Wt.	1610
GOG	3.32
ADG	2.98

Red Cockburn Patriot 9048

Red Bar E-L Anthem 46A  
Red Richmond Rosette SRD 209E  
Red Piro Lady Rosette 315A

April 11/2021  
2273846

## Red Richmond Jingo SRD 56J

92



PV	
BW	70
CR	3
DOC	3
Age of Dam	4
AWW 205 Wt	669
Jan 15 Wt.	1640
GOG	3.21
ADG	2.68

Red Cockburn Patriot 9048

Red Piro Radar 524C  
Red Richmond Marta SRD 13E  
Red Piro Marta 550C





**93****Red Richmond Patriot****Apr 30/21 SRD 191J 2273855**

PV	
BW	80
CR	1
DOC	2
Age of Dam	
4	
AWW 205 Wt	
689	
Jan 15 Wt.	
1625	
GOG	3.66
ADG	2.56

**Red Cockburn Patriot 9048**

Red Richmond Bando SRD 63B  
**Red Richmond Capp SRD 205E**  
 Red Richmond Capp SRD 104C

**Grand Dam****94****Red Richmond Statesman****May 1/21 SRD 198J 2238743**

PV	
BW	85
CR	1
DOC	3
Age of Dam	
6	
AWW 205 Wt	
664	
Jan 15 Wt.	
1535	
GOG	3.06
ADG	2.98

**Red Cockburn Patriot 9048**

Red Crowfoot Rumbler 3182A  
**Red Wilbar Tinsel 832C**  
 Red Wilbar Tinsel 208W

**95****Red Richmond Patriot****May 6/21 SRD 242J 2238744**

PV	
BW	80
CR	2
DOC	3
Age of Dam	
6	
AWW 205 Wt	
670	
Jan 15 Wt.	
1635	
GOG	3.77
ADG	2.44

**Red Cockburn Patriot 9048**

Red Brown JYJ Redemption  
**Red Piro Marta 550C**  
 Red Piro Marta 545R







## Red Richmond Patriot

Apr 14/21 SRD 70J 2273847

Red Cockburn Patriot 9048

Red Piro Mission Statement 130Y  
Red Piro Barbara 3116A  
Piro Barbara 817U



96	
PV	
BW	85
CR	1
DOC	2
Age of Dam	
8	
AWW 205 Wt	
698	
Jan 15 Wt.	
1700	
GOG	3.47
ADG	3.21



## Red Richmond Patriot

Apr 26/21 SRD 161J 2273856

Red Cockburn Patriot 9048

Red Cockburn Cowboy Kind 635D  
Red Richmond Holly SRD 2F  
Red Piro Holly 552C



Grand Dam

97	
PV	
BW	85
CR	1
DOC	2
Age of Dam	
3	
AWW 205 Wt	
703	
Jan 15 Wt.	
1705	
GOG	3.58
ADG	2.68



## Red Richmond Reckoning

Apr 26/21 SRD 163J 2290464

Red SIXM Reckoning 176E

Red Bar E-L Anthem 46A  
Red Richmond Duchess SRD 8F  
Red MEM Duchess 38A

98	
PV	
BW	94
CR	1
DOC	2
Age of Dam	
6	
AWW 205 Wt	
1840	
Jan 15 Wt.	
1840	
GOG	4.10
ADG	3.45



**99**

# Red Richmond Patriot SRD 204J

May 1/2021  
2273828

PV	
BW	80
CR	1
DOC	2
Age of Dam	5
AWW 205 Wt	769
Jan 15 Wt.	1760
GOG	3.58
ADG	2.74

**100**

# Red Richmond Patriot SRD 95J

April 17/2021  
2273848

PV	
BW	70
CR	2
DOC	2
Age of Dam	3
AWW 205 Wt	655
Jan 15 Wt.	1670
GOG	3.13
ADG	4.17





April 27/2021  
2273858

## Red Richmond Patriot SRD 168J

101



PV	
BW	75
CR	2
DOC	2
Age of Dam	
2	
AWW 205 Wt	
653	
Jan 15 Wt.	
1520	
GOG	3.32
ADG	2.38

**Red Cockburn Patriot 9048**

Red Cockburn Cowboy Kind 635D  
**Red Richmond Rosette SRD 166G**  
Red Richmond Rosette SRD 205E

April 29/2021  
2273936

## Red Richmond Revolution SRD 181J

102



PV	
BW	75
CR	2
DOC	3
Age of Dam	
2	
AWW 205 Wt	
716	
Jan 15 Wt.	
1560	
GOG	3.06
ADG	2.62

**Red Cockburn Patriot 9048**

Red Cockburn Cowboy Kind 635D  
**Red Richmond Chayenne SRD 129G**  
Red Richmond Chayenne SRD 103E



**Grand Dam**



**103****Red Richmond Patriot****Apr 28/21 SRD 174J 2273931**

PV	
BW	80
CR	2
DOC	2
Age of Dam	
6	
AWW 205 Wt	
604	
Jan 15 Wt.	
1560	
GOG	3.66
ADG	2.62

**Red Cockburn Patriot 9048**

Red Get-A-Long Wander 905  
**Red Piro Holly 552C**  
 Red Piro Holly 0119X

**104****Red Richmond Cowboy****Apr 17/21 SRD 98J 2238023**

PV	
BW	75
CR	2
DOC	3
Age of Dam	
2	
AWW 205 Wt	
632	
Jan 15 Wt.	
1480	
GOG	3.47
ADG	2.32

**Red Richmond Cowboy SRD 122G**

Red SIMX Reckoning 178E  
**Red Richmond Delicacy SRD 128G**  
 Red Richmond Delicacy SRD 107D

**Grand Dam****105****Red Richmond Cowboy****Apr 23/21 SRD 135J 2238024**

PV	
BW	75
CR	2
DOC	2
Age of Dam	
2	
AWW 205 Wt	
659	
Jan 15 Wt.	
1500	
GOG	3.25
ADG	2.68

**Red Richmond Cowboy SRD 122G**

Red Bar E-L Anthem 46A  
**Red Richmond Brandina SRD 14G**  
 Red Piro Brandina 304A





**A** 7 Reds

**B** 7 Reds

Richmond Ferdinand SRD 90F  
and Richmond Firebird SRD  
222F sired daughters out of  
Simmental heifers.

**SS**

Bred to a proven limo heifer bull.



Due to start calving March 16.



We are looking for more heifer calves with Richmond Ranch genetics to produce commercial bred heifers for the 2024/2025 Richmond Ranch bull Sale. If you are interested in partnering with us on this new growing venture, let us know so we can plan a herd tour and make some plans.

Looking for our bred heifers? We're sorry you missed them but don't worry they are still available. Some big changes have taken place along with moving our sale date. They will be available this spring, calved out, after all the risk and work is done. We will video the pairs in the spring and post the videos. Please leave us your name and we will contact you directly.





## TERMS & CONDITIONS

**Guarantee:** Every lot is sold fully guaranteed. Every bull will be semen tested. We produce a quality product; therefore, we stand behind that product 100%. All bulls will sell under the normal breeder guarantee recommended by the Canadian Limousin Association and the Canadian Angus Association – printed on the back of your receipt. Richmond Ranch is never responsible for more than the value of the sale price of the bull(s) or female(s).

**Terms of the Sale:** Cash or cheque at par, payable to Richmond Ranch LTD at the clerks' desk Sale Day. U.S. funds will be accepted at current rate of exchange. No release will be given until settlement has been made. Please talk to us prior to the sale to make further arrangements. Should any purchaser fail to settle for their purchase; Richmond Ranch reserves the right to resell the animal to their best advantage either publicly or privately, without further notice.

**Disputes:** In the case of any disputes, the Auctioneer will open the bid between the parties involved. If no further bid is made, the buyer will be the person from whom the auctioneer accepted the last bid. The auctioneer's decision in such matters will be final.

**Announcements:** Any announcements from the auction block will take precedence over the printed matter in the catalogue. Buyers are therefore cautioned to pay attention to any such announcements.

**Breeding Protection Plan:** Ownership to the purchaser commences when the Auctioneer's hammer falls. Each animal becomes the risk of the purchaser as soon as sold. Livestock Breeding Protection Plan will be available by adding 10% to your invoice at the clerk's desk. \* \$500 minimum\*

**Accidents:** Those who attend the Sale do so at their own risk. Neither Richmond Ranch, sales staff, or the auctioneer assumes any responsibility in the matter, and disclaims any legal or otherwise in the event of an injury, accident, or loss of or damage to property or person.

**Delivery Options:** We encourage you to discuss arrangements prior to the sale. Bulls will be delivered free of charge to central points in Western Canada (Alberta & Saskatchewan) at Richmond Ranch's convenience and at owner's risk. For cattle going to Eastern Canada or the US, we will arrange trucking at minimal cost to the buyer. If this delivery time is not convenient for the buyer, the bull(s) or female(s) will be kept free of charge and the buyer can pick-up the bull(s) at their convenience. Richmond Ranch recommends that all bulls left on site are to be enrolled in the Breeding Protection Plan or Insured.

**Transfer of Paper:** The registration papers will be transferred to the new owner upon receiving payment in full.

**Semen Collection:** Richmond Ranch reserves the right to collect in-herd use semen on any bull in the sale. This will occur at the expense of Richmond Ranch and at the buyer's convenience.

**Sight Unseen Purchase Plan:** If you are unable to attend sale day, we would be more than happy to assist you in your sale selection. Please feel free to contact any member of the Richmond Family or any of the sales staff. Every effort will be made to get you the right bull or bulls, at the right price to make you a repeat customer.

**Homozygous Polled Testing** was completed at NeoGen. Richmond Ranch does not guarantee the results. EPD's are available upon request. They can be found on each respective breed association website.

By attending the Richmond Ranch Bull & Female Sale, you are granting permission for your picture to be used for promotional and advertising purposes related solely to the Richmond Ranch Bull & Female Sale.



Return Undeliverable  
Canadian Addresses To:

Richmond Ranch Ltd.  
P.O Box 58  
Rumsey, AB  
TOJ 2Y0



Thursday February 16th, 2023  
1:00 PM AT THE RANCH, RUMSEY AB

*WHERE QUALITY ISN'T A GOAL, IT'S A STANDARD*

---

***WWW.RICHMONDRANCH.COM***

